

News Alert

No 22 - July 24th, 2008

New rugged sensor for very harsh environments

Recently, APEM has been asked to develop a limit switch for a manufacturer of agricultural equipments.

What is a limit switch ?

A limit switch is an electro-mechanical device consisting of an actuator mechanically linked to a set of contacts. When an object comes into contact with the actuator, the device operates the contacts to make or break an electrical connection.

This custom switch has been entirely developed to our customer's specifications. Its function is to detect the extreme position of the clutch pedal, to operate the electrical clutch in a very harsh environment (vibrations, shocks, humidity, extreme temperatures, ...)

APEM has been chosen because of its strong skills in switching. We designed a very reliable custom product, with a higher sealing level compared to products from the competition. Our vertical integration has allowed us to develop and manufacture this product on the basis of a screw machining technology. The result is a very reduced tooling cost, and a fast development.

This new 100% custom product can be sold as a standard product.

Features

- Stainless steel actuator
- Protection: rear IP67 ; front IP40
- Temperature: -30°C to +65°C
- Electrical life: 1.000.000 cycles
- Rating : 2A 12Vdc
- Contact: silver

Applications

- Processes
- Off-road vehicles : construction vehicles, agricultural equipment
- Utility vehicles

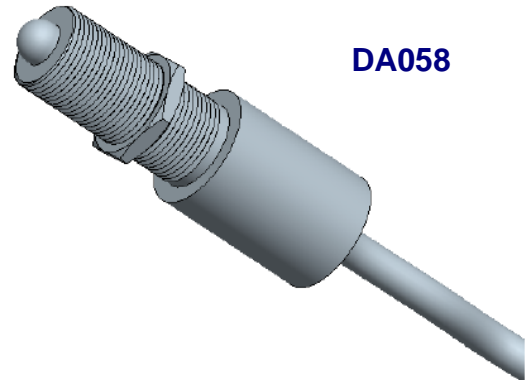

DA058

Suggested end-user price : 25 € each in 1,000 piece quantities – PN : DA058

Additional information : pierre.lavergne@apem.fr Marketing and Communication Manager



APEM

switches



keyboards



joysticks

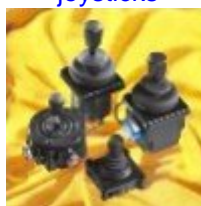

indicators

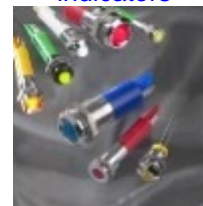

custom products

